

Configuring Targetprocess

Configuring Targetprocess for single sign-on (SSO) enables administrators to manage users of Citrix ADC. Users can securely log on to Targetprocess by using the enterprise credentials.

Prerequisite

Browser Requirements: Internet Explorer 11 and above

To configure Targetprocess for SSO by using SAML:

1. In a browser, type <https://www.targetprocess.com/> and press **Enter**.
2. Type your Targetprocess admin account credentials (**Email** and **Password**) and click **Log in**.

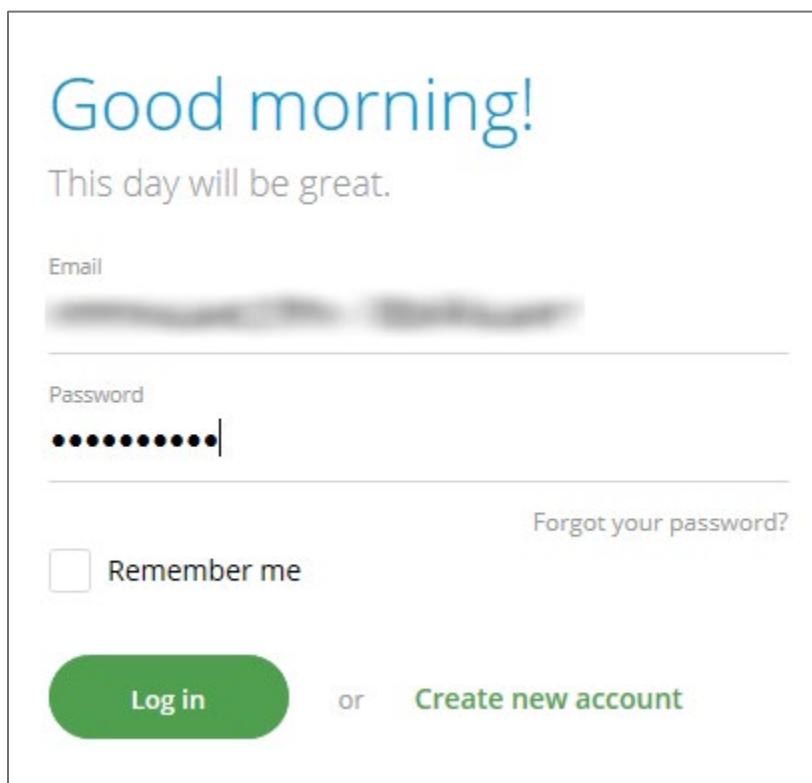

Good morning!

This day will be great.

Email

Password

Remember me

[Forgot your password?](#)

or [Create new account](#)

3. In the login page, click **Settings** from the **Settings** drop-down menu.

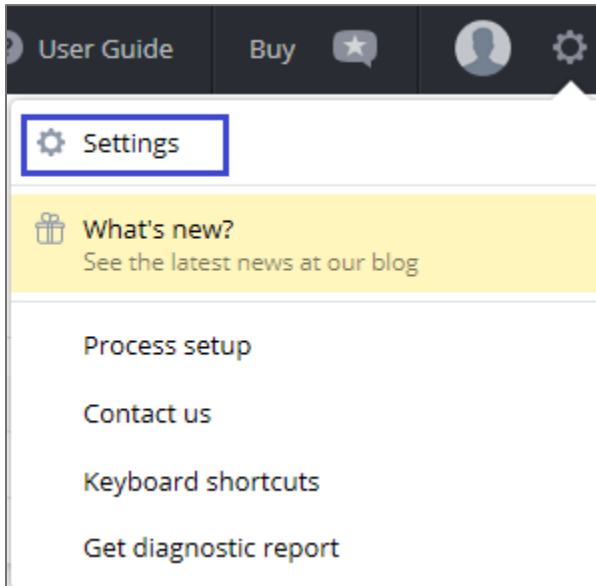

4. In the left panel, click **Authentication and Security**.

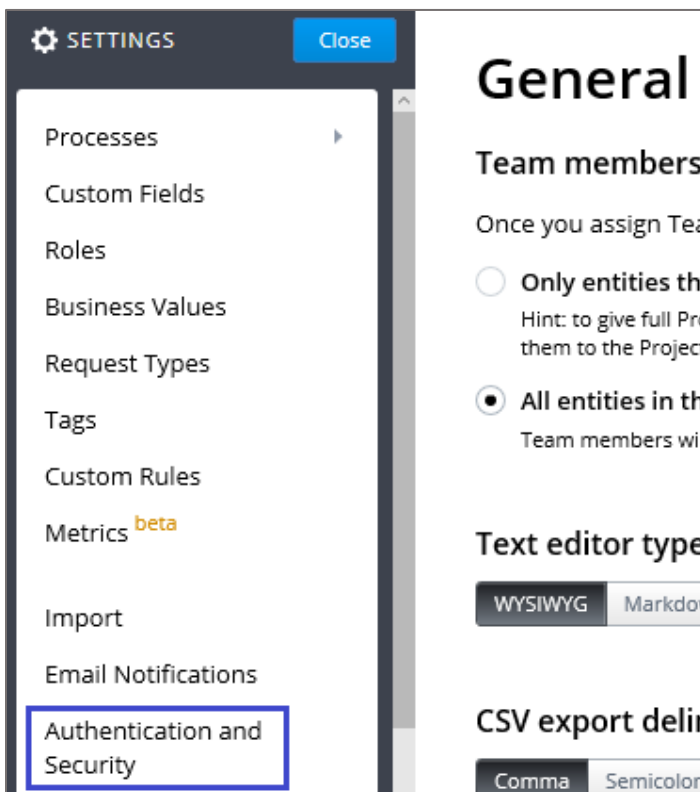

- In the **Authentication and Security** page, click the **Single Sign-On** tab.

Authentication and Security

Single Sign-On
System User
Security

Set up Single sign-on to log in to Targetprocess via SAML-using identity providers. See [our general article on SSO](#) and guides for integration with specific providers:

[Okta](#)

[Onelogin](#)

[Google Apps for Business](#)

[Azure AD](#)

[Active Directory Federation Services](#)

- In the **Authentication and Security** page, enter the values for the following fields:

Field name	Description
Enable Single Sign-On	The checkbox is enabled by default.
Sign-on URL	IdP logon URL.
X.509 Certificate	Copy and paste the IdP certificate. The IdP certificate must begin and end with -----Begin Certificate----- and -----End Certificate----- Note: The IdP certificate is provided by Citrix and can be accessed from the link below: https://ssb4.mgmt.netscalergatewaydev.net/idp/saml/templatetest/idp_metadata.xml

TARGETPROCESS INFORMATION

Use these values to configure a connector in your identity provider settings:

Assertion Consumer URL: `https://<customer_domain>.tpondemand.com/api/sso/saml2`

Enable Single Sign-on

Sign-on URL:

Certificate:

Enable JIT Provisioning ?

Disable login form ?

7. To enable SAML SSO for users, add their email IDs to the **Exceptions list**.

Exceptions list — allow these users to log in with their logins and passwords (the form is available at [https:// \[redacted\].tpondemand.com/login.aspx?login=form](https://[redacted].tpondemand.com/login.aspx?login=form)):

Save

8. Finally, click **Save**.

Note: The **Save** button is enabled after you add users to the **Exceptions list**.